

First cable car in Scandinavia for Bartholet Ropeways Narvik, Norway (Section 2)

Bartholet Ropeways is currently building a 10-passenger gondola lift in Narvik, Norway. With this project BMF can expand its portfolio with the first 10-passenger gondola lift and at the same time gain ground in Scandinavia. The construction began in spring 2018 and the work is proceeding according to the plan. The installation is scheduled to go into operation at the beginning of December 2018.

The new gondola lift will replace an existing system on a new route. With the new installation, not only the capacity but also the comfort is considerably increased because of the the gondolas with the premium version "Design by Porsche Design Studio". The increase in capacity from 350 to 1'600 passengers/hour is important because Narvik is a popular destination for cruise ships. This means that many people must be transported within a short period of time.



Rendering 10-passenger gondola Narvik Section 2

The ropeway is one of the most popular tourist attractions in Narvik. It takes visitors to a viewing platform and a restaurant on the Narvikfjellet, 656 m a.s.l. The top of Narvikfjellet offers a spectacular view over the city and the surrounding countryside. Hikes are just as possible as sleigh rides and ski tours in winter. The entire offer on the mountain is to be expanded in the future. Therefore the capacity of the new installation can be extended from 1'600 to 2'400 pers./h at any time.

**Bartholet
Maschinenbau AG**
Seilbahnen

Lochriet
CH – 8890 Flums

tel +41 (0) 81 720 10 60
fax +41 (0) 81 720 10 61

admin@bmf-ag.ch
www.bmf-ag.ch

**Ein Unternehmen
der BMF Group AG**

Seilbahnen
Maschinenbau
Lasertech
Grossbearbeitung
Swiss Rides
Swiss Road Trains
Solar Wings

Ein Mitglied
der Cobinet-Gruppe
www.cobinet.ch

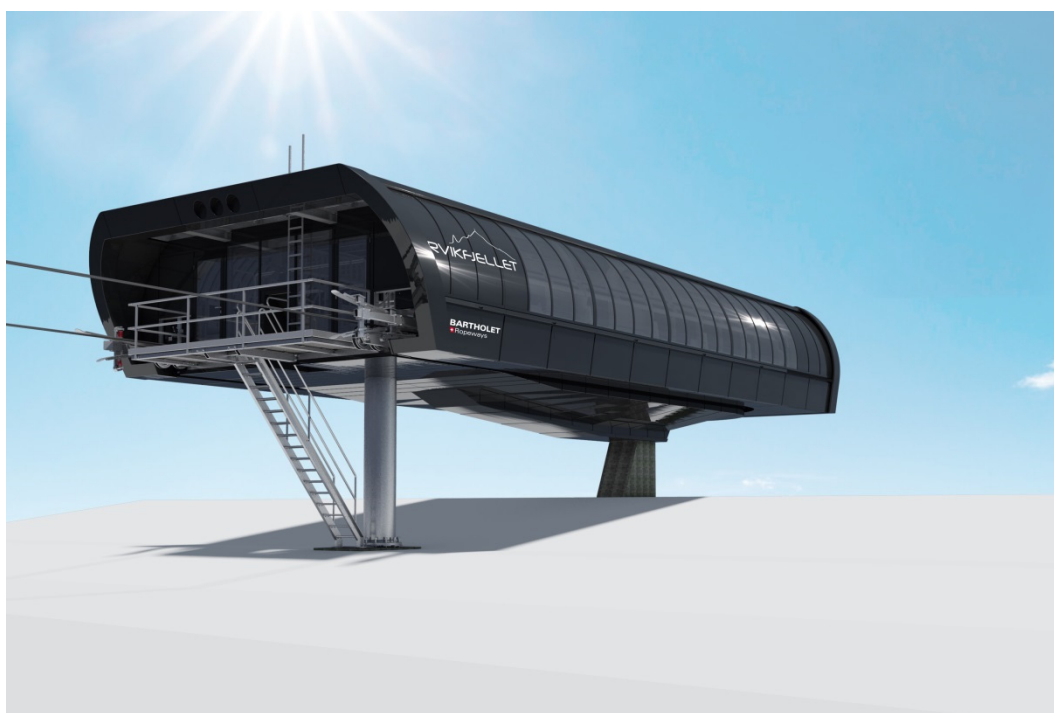

Rendering Station Narvik Section 2



Sektion 2: 2018 (10er-Gondelbahn)
Sektion 1: in 2 bis 3 Jahren (urbane Seilbahn)

In the next two to three years another ropeway (section 1) should be built in Narvik. It will take the tourists from the city centre to the valley station of the gondola lift which is currently under construction (□ section 2) and at the same time relieve the city traffic. Most probably this installation will also be equipped with gondolas. At the middle station (Skistua), a large hotel complex will be built. One cable car takes its guests into town and the other takes them to the observation deck on Narvikfjellet.

Bartholet
Maschinenbau AG
 Seilbahnen

Lochriet
 CH – 8890 Flums

tel +41 (0) 81 720 10 60
 fax +41 (0) 81 720 10 61

admin@bmf-ag.ch
 www.bmf-ag.ch

Ein Unternehmen
der BMF Group AG

Seilbahnen
 Maschinenbau
 Lasertech
 Grossbearbeitung
 Swiss Rides
 Swiss Road Trains
 Solar Wings

Ein Mitglied
 der Cobinet-Gruppe
 www.cobinet.ch

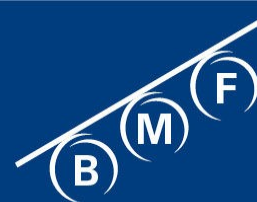

BARTHOLET
+ Seilbahnen

Commissioning :	2018
Installation type:	Gondola lift with 10-seat gondolas “Design by Porsche Design Studio“
Valley station:	223 m a.s.l.
Top station:	662 m a.s.l.
Vertical rise:	439 m
Inclined length:	1'172 m
Number of vehicles:	23 (final expansion: 36)
Number of towers:	8 pcs.
Driving speed:	6 m/s
Capacity :	1'600 pers./h (2'400 pers./h)
Drive:	548 kW
Grip system:	detachable
Rope :	52 mm
Control system:	Nidec

**Bartholet
Maschinenbau AG**
Seilbahnen

Lochriet
CH – 8890 Flums

tel +41 (0) 81 720 10 60
fax +41 (0) 81 720 10 61

admin@bmf-ag.ch
www.bmf-ag.ch

**Ein Unternehmen
der BMF Group AG**

Seilbahnen
Maschinenbau
Lasertech
Grossbearbeitung
Swiss Rides
Swiss Road Trains
Solar Wings

Ein Mitglied
der Cobinet-Gruppe
www.cobinet.ch

 Schweizer Qualität